

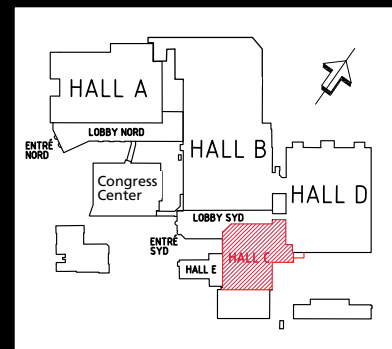

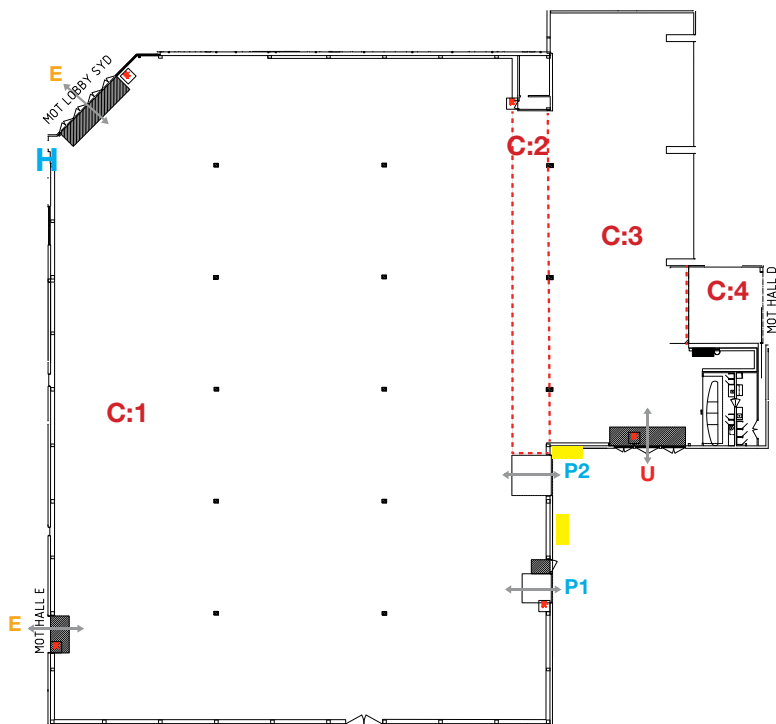

Hall C

Hall C can act as an extension of Hall D or as a separate exhibition hall. Hall C is reached from Lobby Syd. In Hall C there is a coffee shop, Café Exprezz. Hall E is reached via Hall C.



-  Fire hydrant
-  Waste and Recycling Center
-  Elevator door: 90x200 cm
area: 160x110 cm
10 people, 750 kg

E Visitor entrance **P** Vehicle entry doors **U** Exit outdoor

Section	C:1	C:2	C:3	C:4
Floor space, (ca) m ²	3 455	130	630	60
Overhead ceiling clearance, m	3,1-5,0	4,2	4,2-5,5	3,8
Floor loading, kg/ m ²	4 000	4 000	4 000	4 000
Vehicle entry doors 1, m, h x b	3,0 x 3,0			
Vehicle entry doors 2, m, h x b	4,2 x 4,2			
Comfort cooling	yes	yes	yes	yes
Basic lightning	yes	yes	yes	yes
Daylight	no	no	no	no

Main Services (can be rented from Exhibitors Services)	Yes	No	Comments
Electricity 220 V 10 A	x		
Electricity 400 V 16-125 A	x		
Electricity 400 V 150-400 A	x		
Water	x		1/2 connection, pressure up to 5 kg/sq. cm
Waste water	x		Pumped from stand up to ceiling
Compressed air	x		up to 6 kg/sq. cm
Wire suspension from ceiling	x		
WiFi	x		
High Speed Internet	x		